



# H Y E R

## OFFICE FURNITURE

Price & Specification Guide

2026 State Of Georgia Net D & I

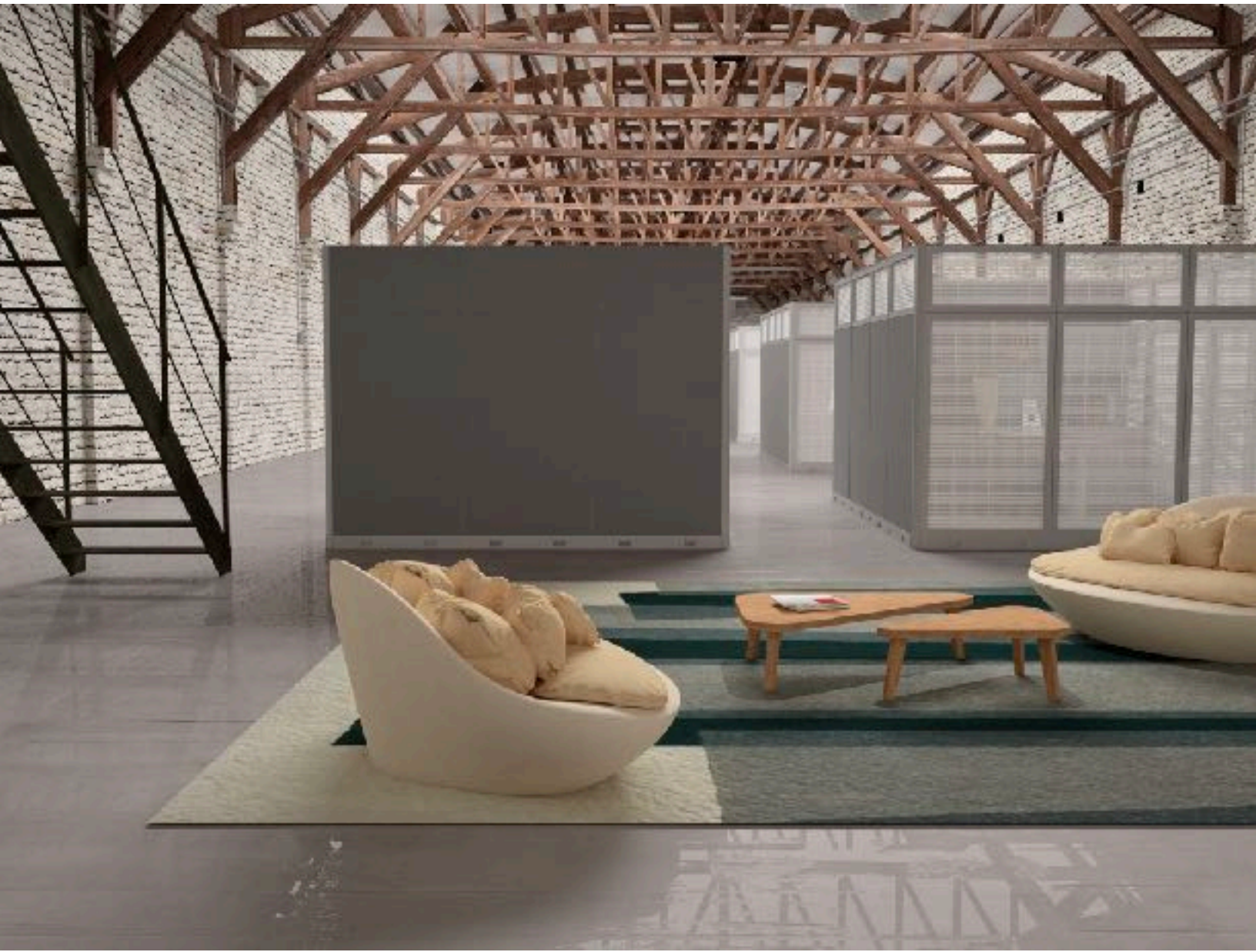

**Introduction .....3**

Warranty .....3

Shipping .....4

Returns .....5

In-Stock program .....5

**Pricing.....6**

Panels .....7

Stack tiles .....8

Work surfaces & tops.....9

Storage components .....10

Work surface supports & understructures .....11

Work surface supports & understructures Cont'd.....12

Screens .....13

Accessories .....13

Modular door.....14

Modular laminate hutch .....15

Desk top Power-bar .....16

Power .....17

**SEATING.....18**

**Parts .....19**

Cantilevers .....19

Screws .....20

Connecting kits .....20

**Specification rules/guidelines .....21**

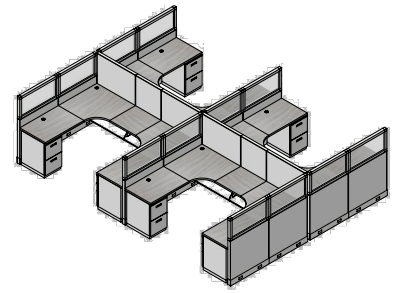
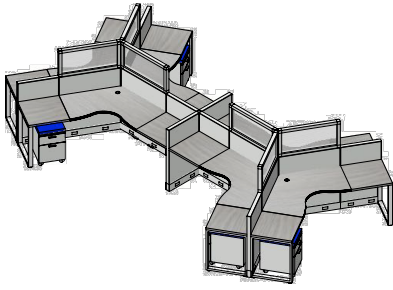

## INTRODUCTION

The P55 is a 2.25" (55mm) metal clad, monolithic, stackable panel and modular furniture system. P55 panels are stocked in a variety of heights and widths allowing for almost infinite configurations. Panels and stack tiles are stocked in fabric over metal (W), glass (G) and etched glass (GE). Work surfaces are straight edged with a 2 mm pvc edge banding and include wire management grommets. Top caps and raceway covers are powder coated aluminum and steel. All panels come standard with a CAT6 compliant divided raceway and hangers for Byrne 8-track UL approved modular power system. All panels connect with provided hardware and use machine screws into machine receivers.

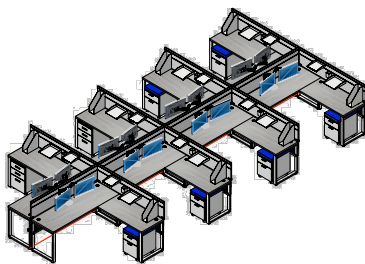

The P55 is the erector set of office furniture. You are able to build to suit your needs and your available space. From the same parts we are able to construct freestanding private office furniture, open plan freestanding desks, hybrid workstations, traditional workstations or cubicles; even walls, rooms and doors. This built in flexibility results in design support for different levels of privacy and/or collaboration throughout

an organizations workspace with system that is designed to all work together. Designed for ease of reconfiguration, multipurpose use, and a lifetime of service.

## WARRANTY

Hyer guarantees the P55 system for life, when installed by a Hyer certified installer. This warranty is not transferable and is only available to the original purchaser. This warranty is valid only through the original authorized dealer under which it was purchased, and must be accompanied by a sales receipt. Our warranty covers faults or defects from the manufacturing process. It does not cover abuse or damage resulting from the improper use, care or assembly of the product. Our warranty is limited to repair or replacement of said product at our discretion.



# SHIPPING

We can ship prepaid to your dock on any order that exceeds the following minimums. Orders below the minimum are subject to “not to exceed” charges listed below. Freight charges will not exceed actual charges to Hyer.

ZONE	MINIMUM DEALER NET	< Min Charge
1	\$5,000.00 net	\$125.00
2	\$15,000.00 net	\$250.00
3	\$20,000.00 net	\$500.00
4	\$25,000.00 net	\$1,500.00
5	\$35,000.00 net	\$2,500.00



All furniture should be carefully inspected upon receipt. All items are packaged for freight shipping to reduce the likelihood of damage during handling. Shortages or any visible damage to the shipping cartons and/or the furniture should be noted on the carrier's Bill of Lading and reported to the carrier and Hyer immediately. YOU MUST ACCEPT ALL SHIPMENTS. Your proper and timely execution of the carrier's Bill of Lading will enable us to better assist you. If you adhere to the above procedures, Hyer will handle the filing of the freight claim and ship any replacement parts to you at no charge. Failure to notify Hyer or its agent within 5 business days from the receipt of goods constitutes a waiver of claim. REFUSING TO ACCEPT ANY SHIPMENT WILL RESULT IN ADDITIONAL FREIGHT CHARGES TO YOU.

Possession of this price list does not constitute an offer to sell. Hyer Office Furniture may only be purchased through its network of authorized dealers. Hyer or its agent will retain full ownership of the goods as listed on invoices until the amount is paid in full. Shipments may be held due to a dealership's failure to comply with credit requirements or pay any past due invoices. A dealer's purchase order must be complete, numbered, dated and acknowledged by Hyer or its agent prior to pickup or shipping.

Prices, specifications and packaging are subject to change without notice. Weights and cubes are approximate and may vary due to improvements and changes in products or packaging. We constantly strive to improve our offering. When items are changed, added or deleted, timely notice will be given to all authorized dealers and distributors. This price list has been checked for errors. Every effort has been made to provide you with a complete and informative overview of our product. We will not be held responsible for errors or omissions in

this price list. Use this price list as a guide. Our acknowledgment overrides all agreements verbal or written.

## RETURNS

All sales are final, but changes occur. If the product is returned unopened and undamaged we will credit the account (minus incurred shipping charges). If product is special order or custom there is no refund or exchange policy. We reserve the right to evaluate each request on a case by case basis.

## IN-STOCK PROGRAM

All panels carried in the In-Stock program come in a three tone gray Fuchi fabric (V-310). All metal components are Light Gray (905). All work surfaces are two sided and are finished in genuine Formica high pressure laminate - Light Gray (L-905) and SilverOak (0869V). In-stock systems furniture is available on a first come, first served basis. Orders will be processed in the order in which they are received. Dealers will be notified via acknowledgment within 24 hrs. All systems orders over \$5,000.00 Net will require a 50% deposit. Product will be available for pick-up or shipping within 5 business days from the date of our acknowledgment or receipt of the deposit, whichever comes later. Orders with accelerated lead times (72hrs) will be evaluated on a case by case basis.

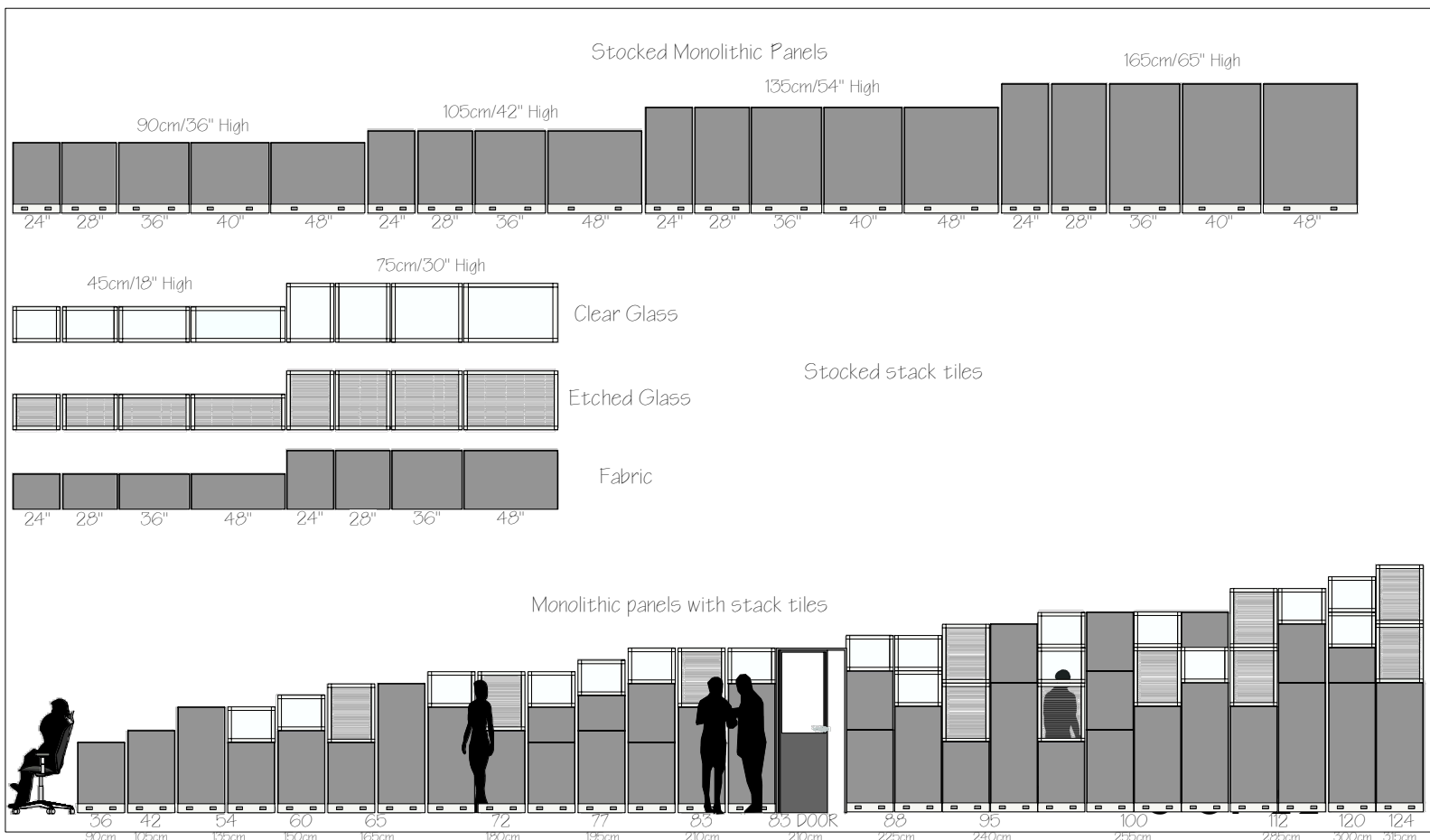

# PRICING

All prices are List. Dealer discounting is assigned on a project by project basis. Specifying dealers, on registered projects, get preferential pricing. Projects are registered only to dealers in good credit standing with open accounts. Registration will be confirmed prior to the design process. To register a project please contact our office.

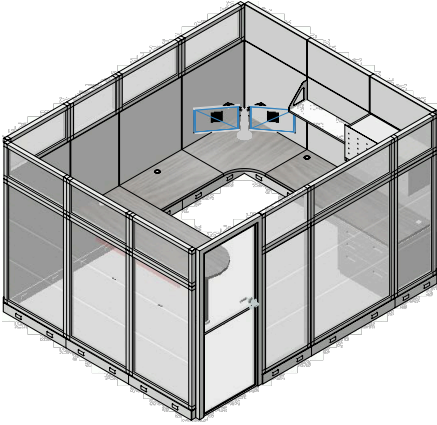

All major components include the cost for the necessary hardware and trim. All Orders must be accompanied by the matching Hyer quote and drawing. Hyer will provide installation drawings and a parts/pull list for each project.

Orders for parts without corresponding major components will have a charge. A parts price list is included in this guide for costing on individual connection kits required for reconfigurations.

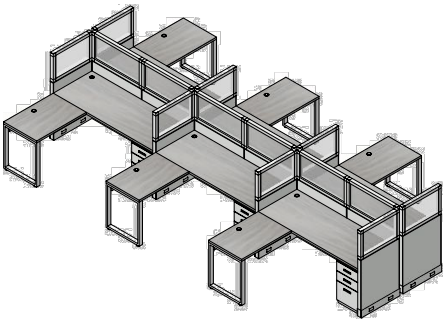

Design and specification assistance is included in our service at no charge. To begin your process in design and specification please contact our office. Most design requests are returned in 24-48 hrs.



# PANELS

Panels are available through our in-stock program in 72 hrs. Please refer to page 5 under the heading "INISTOCK PROGRAM", or contact our office for more detailed information. All required mounting hardware and trim are included.

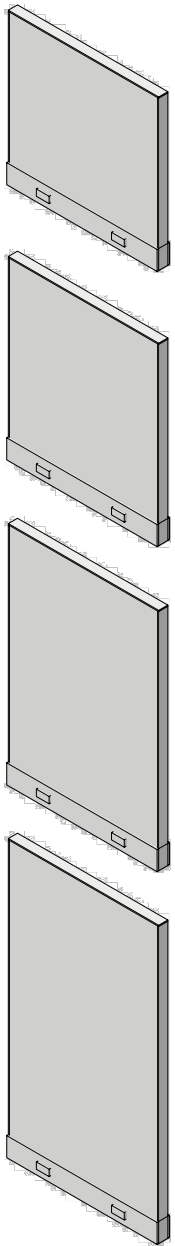

SKU	Nominal Size			State of GA Net Price D & I			
	Height	Width	Thickness	W-Fabric	G-Glass	GF-Frosted Glass	GE-Etched Glass
P9060-S	36	24	2.2	169.65			
P9070-S	36	28	2.2	1714.54			
P9090-S	36	36	2.2	227.33			
P90100-S	36	40	2.2	255.23			
P90120-S	36	48	2.2	261.26			
P10560-S	42	24	2.2	194.91			
P10570-S	42	28	2.2	207.73			
P10590-S	42	36	2.2	265.79			
P105120-S	42	48	2.2	304.24			
P13560-S	54	24	2.2	224.69			
P13570-S	54	28	2.2	230.35			
P13590-S	54	36	2.2	310.65			
P135100-S	54	40	2.2	342.32			
P135120-S	54	48	2.2	363.05			
P16560-S	65	24	2.2	273.70		385.29	398.49
P16570-S	65	28	2.2	275.21		418.47	448.63
P16590-S	65	36	2.2	374.74		505.18	597.92
P165100-S	65	40	2.2	408.29			
P165120-S	65	48	2.2	431.29		587.37	697.83

# STACK TILES

Stack Tiles come with all required mounting hardware and trim. Available in two heights, tiles can be stacked on panels or on themselves for the ultimate in height flexibility.

SKU	Nominal Size			State of GA Net Price D & I		
	Height	Width	Thickness	F-Fabric	G-Glass	GE-Etched glass
PH4560	18	24	2.2	95.38	103.68	115.36
PH4570	18	28	2.2	105.18	115.36	128.18
PH4590	18	35	2.2	119.51	140.62	157.96
PH45100	18	40	2.2	124.03	160.60	178.70
PH45120	18	47	2.2	128.56	182.85	203.58
PH7560	30	24	2.2	134.59	160.98	190.76
PH7570	30	28	2.2	152.69	174.17	210.74
PH7590	30	35	2.2	185.86	205.84	251.08
PH75120	30	47	2.2	225.07	255.61	295.57

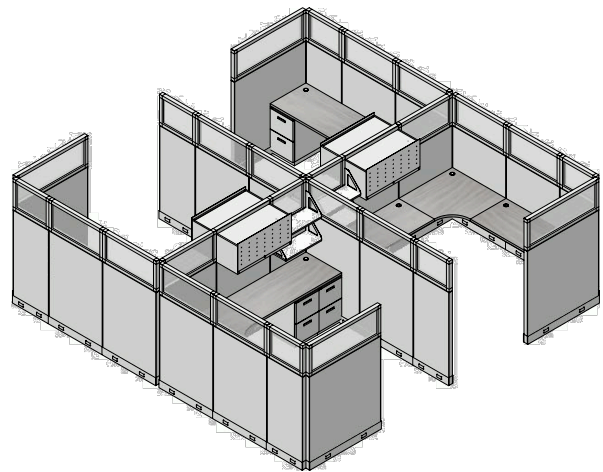
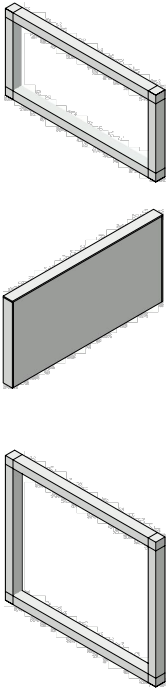

# WORK SURFACES & TOPS

Panel hung work surfaces and transaction counters include cantilevers and screws required for installation. Tops or freestanding furniture will need an appropriate base structure in addition to the top. Custom surfaces or special cuts are available by request.

SKU	Nominal Size			State of GA Net Price D & I	Description
	Height	Width	Depth		
PC90A	1	36	18	115.36	TRANSACTION TOP
PC120A	1	48	18	127.05	TRANSACTION TOP
PC140A	1	55	18	141.00	TRANSACTION TOP
PC150A	1	60	18	156.08	TRANSACTION TOP
PC160A	1	63	18	173.04	TRANSACTION TOP
PC180A	1	71	18	184.35	TRANSACTION TOP
PT66	1	24	24	108.58	RECTANGULAR
PT76	1	28	24	112.72	RECTANGULAR
PT96	1	36	24	132.33	RECTANGULAR
PT106	1	40	24	157.96	RECTANGULAR
PT126	1	48	24	167.01	RECTANGULAR
PT146	1	55	24	207.35	RECTANGULAR
PT156	1	60	24	227.71	RECTANGULAR
PT166	1	63	24	251.08	RECTANGULAR
PT186	1	71	24	268.05	RECTANGULAR
PT67	1	24	28	184.35	RECTANGULAR
PT77	1	28	28	195.29	RECTANGULAR
PT97	1	36	28	196.04	RECTANGULAR
PT107	1	40	28	197.55	RECTANGULAR
PT127	1	48	28	205.84	RECTANGULAR
PT147	1	55	28	216.78	RECTANGULAR
PT157	1	60	28	253.34	RECTANGULAR
PT167	1	63	28	355.51	RECTANGULAR
PT187	1	71	28	371.72	RECTANGULAR
PT159	1	60	36	390.20	RECTANGULAR
PT189	1	71	36	425.63	RECTANGULAR
PT189 NG	1	71	36	425.63	RECTANGULAR NO GROMMET
PT906P-R	1	36	24	232.61	CORNER
PT90R	1	36	36	237.51	ROUND
PT9060-120	1	60	24	367.58	WING 120° CORNER
PT1607U	1	63	28	340.05	D-TOP
PT1807U	1	71	28	401.13	D-TOP
PT1	1	15	17.7	173.42	PED TOP-SINGLE
PT2	1	30	17.7	227.33	PED TOP-DOUBLE
PT3	1	45	17.7	220.92	PED TOP-TRIPPLE
PT120120 NG	1	48	48	307.26	48" SQUARE NO GROMMET

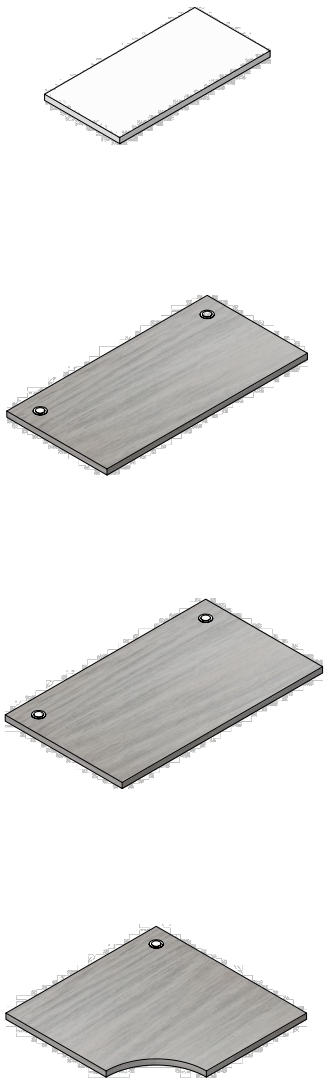

# STORAGE COMPONENTS

Panel hung storage components include all necessary mounting hardware. Floor supported components all include height adjustable feet (or casters).

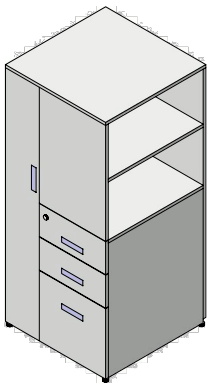
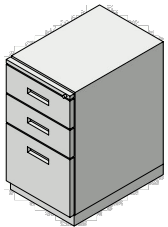
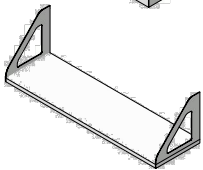
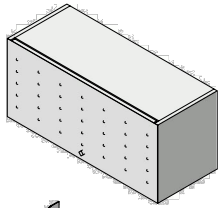

SKU	Nominal Size			State of GA Net Price D & I	
	Height	Width	Depth	Description	
PU60L	16.5	24	14	291.80	CLOSED BINDER BIN
PU70L	16.5	28	14	325.35	CLOSED BINDER BIN
PU90L	16.5	36	14	374.74	CLOSED BINDER BIN
PU100L	16.5	40	14	387.93	CLOSED BINDER BIN
PU120L	16.5	48	14	412.82	CLOSED BINDER BIN
PS60	10	24	11	102.92	OPEN SHELF
PS70	10	28	11	108.58	OPEN SHELF
PS90	10	36	11	114.61	OPEN SHELF
PS100	10	40	11	117.25	OPEN SHELF
PS120	10	48	11	122.53	OPEN SHELF
MA-311	28	15	22.5	445.61	FF PEDESTAL
MA-312	28	15	22.5	461.83	BBF PEDESTAL
MA-235	24	15	20	385.67	MOBILE BF PEDESTAL
MBF CUSHION	2	15	20	150.80	CUSHION
TC135 L/R	54	24	24	1774.16	WARDROBE COMBO
PM90	11	36	4	151.93	BINDER RACK
SB-06C	2	23	18	86.71	PENCIL DRAWER
MA 1.5 LBF	22	30	18	574.55	1.5 LAT CASE BF
MA 1.5 LBC	22	30	18	392.83	1.5 LAT BOOK CASE
MA LF236	30	36	18	771.72	2 DRAWER LATERAL
MA BC2	30	36	18	405.65	LAT OPEN CASE 1 ADJ
MA OP B/LAT	27.5	30	18	767.95	B/F LATERAL ON LEGS
MA OP BC	27.5	30	18	575.68	OPEN BC ON LEGS

# WORK SURFACE SUPPORTS & UNDERSTRUCTURES

Under structures are to support surfaces in a non-panel supported environment.

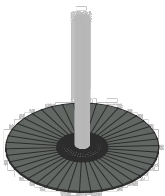
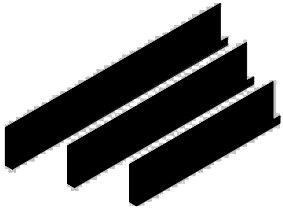
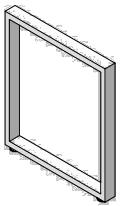
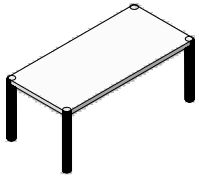

SKU	Nominal Size			State of GA Net Price D & I	Description
	Height	Width	Depth		
TB1809	29	64	24	165.88	TABLE BASE W/SKIRT
TB 1560 WD F&R	29	64	22	279.36	FLIP AND ROLL BASE
HI-LO-112	24-42	48	24	640.90	HEIGHT ADJUST BASE
HI-LO-WIDE-150	24-42	48-72	24	650.33	HEIGHT ADJUST BASE
BL33	22	2.25	14	71.25	OPEN BOX LEG-HUTCH
BL35	28	2.25	12	97.64	OPEN BOX LEG - 1/2
BL60	28	2.25	24	99.91	OPEN BOX LEG
BL70	28	2.25	28	113.85	OPEN BOX LEG
BL90	28	2.25	36	131.57	OPEN BOX LEG
BL60M	28	2.25	24	125.16	BOX LEG W/CASTERS
BLB-R	5	5	0.25	30.16	BL SUP BRACE-RIGHT
BLB-L	5	5	0.25	30.16	BL SUP BRACE-LEFT
MS-TBASE	28	2.25	20	271.06	T BASE LEG
SB TB EIC-L				180.58	EXTERIOR LEG KIT
SB TB EIC-LC				119.89	INTERIOR LEG KIT
SB TB EIC-LR				42.22	REINFORCEMENT KIT
MP120	12	48	2.25	87.84	MODESTY PANEL
MP150	12	60	2.25	114.23	MODESTY PANEL
MP180	12	71	2.25	141.38	MODESTY PANEL
LT-08L	28	3	3	271.06	POST BASE
BT-08L	28	3	3	346.84	FLUTED POST BASE
MS10205C	28	2	2	97.64	POST W/ CASTER
MSTTP-3R	12	3	3	119.51	TRANSACTION POST
OT DESK				1756.07	ADJUSTABLE HEIGHT

# WORK SURFACE SUPPORTS & UNDERSTRUCTURES CONT'D

SKU	Nominal Size			State of GA Net Price D & I	Description
	Height	Width	Depth		
AVENTURA TYPE 1	29		24		LEG FOR 60 DEEP
AVENTURA TYPE 2	29		36		LEG FOR 90 DEEP
AVENTURA TYPE 3	29		48		LEG FOR 120 DEEP
AVENTURA TYPE 4	42				LEG BAR HEIGHT
AVENTURA TYPE 5	29		12		LEG CENTER SUPPORT
AVENTURA MODESTY PANEL	12	48	2		MODESTY BOARD
AVENTURA CABLE WAY	12	48	72		CABLE TROUGH
SUPPORT BARS FOR 120L	2	48	2.25		BAR FOR 120L
SUPPORT BARS FOR 150L	2	60	2.25		BAR FOR 150L
SUPPORT BARS FOR 180L	2	72	2.25		BAR FOR 180L



# SCREENS

Acrylic screens can go both above or below surface. Slat wall screens can hold our accessories on page 13

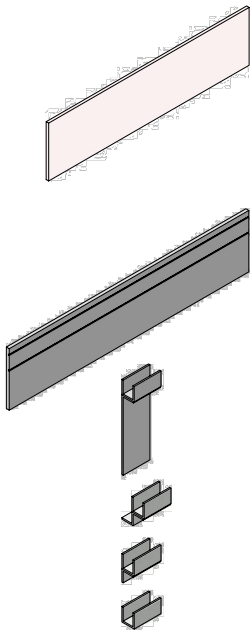

SKU	Nominal Size			State of GA Net Price D & I	Description
	Height	Width	Thickness		
PSC3050-A	12	20	0.25	102.17	ACRYLIC SCREEN
PSC3060-A	12	24	0.25	108.58	ACRYLIC SCREEN
PSC30120-A	12	48	0.25	200.56	ACRYLIC SCREEN
PSC40120-M	16	48	0.75	97.64	SLAT WALL SCREEN
PSC40150-M	16	60	0.75	122.15	SLAT WALL SCREEN
PSC40180-M	16	71	0.75	139.49	SLAT WALL SCREEN
SBAMM	18	2	1	20.74	ACRYLIC MOD MNT KIT
SMK-1	2.25	4	2	16.59	SCREEN MOUNT KIT-LEG
SMK-2	2.25	4	2	15.08	SCREEN MOUNT KIT-U
SMK-3	2.25	4	2	15.46	SCREEN MOUNT KIT-S
SMK-4	2.25	4	2	19.60	SCREEN MOUNT KIT-O
WSS	1	40	2	30.16	SURFACE STIFFENER
WMK		2.25	2.25	86.71	PANEL WALL MOUNT
WT100	40	1	2	30.16	WALL TRACK

# ACCESSORIES



SKU	Nominal Size			State of GA Net Price D & I	Description
	Height	Width	Depth		
AR90	6	36	1	50.90	ACCESSORY RAIL
AR120	6	48	1	72.76	ACCESSORY RAIL
A4	3	13	13	26.01	LETTER TRAY
B4	3	15	15	32.80	LEGAL TRAY
AA4	15	6	15	42.60	BINDER TRAY
PO1	6	3	3	12.44	PENCIL CUP
MA1	15	12	6	197.17	MONITOR ARM SINGLE
MA2	15	30	6	267.67	MONITOR ARM DOUBLE
MWB	12	12	0.25	39.21/sq.ft	MAGNETIC WHITE BAORD

# MODULAR DOOR

Doors are handed and must be specified accordingly. Doors may go in a 2-way and/or 3-way intersection. Doors may be wall started. All doors come with locking commercial hardware.

SKU	Nominal Size			State of GA Net Price D & I	Description
	Height	Width	Depth		
P5590DK-W	83	36	2.25	1042.03	Full Fabric Door
P5590DK-WG	83	36	2.25	1117.43	1/2 Fabric 1/2 Clear Glass
P5590DK-WGE	83	36	2.25	1122.33	1/2 Fabric 1/2 Etched Glass
P5590DK-WGF	83	36	2.25	1126.85	1/2 Fabric 1/2 Frosted Glass
P5590DK-G	83	36	2.25	1213.94	Full Clear Glass Door
P5590DK-E	83	36	2.25	1257.30	Full Etched Glass Door
P5590DK-F	83	36 <td 2.25	1300.65	Full Frosted Glass Door	
DSCM	5	10	4	141.00	DOOR SOFT CLOSE MECHANISM

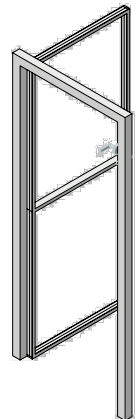
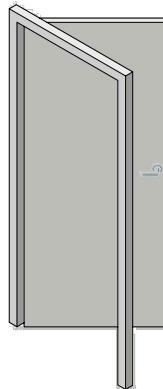
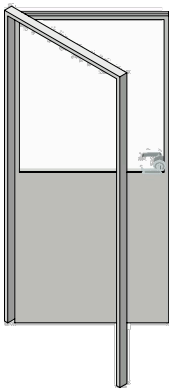

# MODULAR LAMINATE HUTCH

A modular hutch that can be wall or surface supported to suit your design needs. Available with optional sliding door or soft close hinged doors, and a slat wall or painted metal (dry erase) back.

SKU	Nominal Size			State of GA Net Price D & I	Description
	Height	Width	Depth		
H01800	15.5	71	14	661.26	OPEN HUTCH CASE
HB18055-P	22	71	0.75	133.84	PAINTED METAL BACK
HB18055-M	22	71	0.75	235.25	SLAT WALL BACK
HD9040-S	20	36	1	268.42	SLIDING DOOR
HD9040-H	20	36	1	280.11	Soft Close Flipper Door
BL33	22	2.25	14	71.25	Hutch Support Leg
HWMK	6	60	1	65.22	HUTCH WALL MOUNT

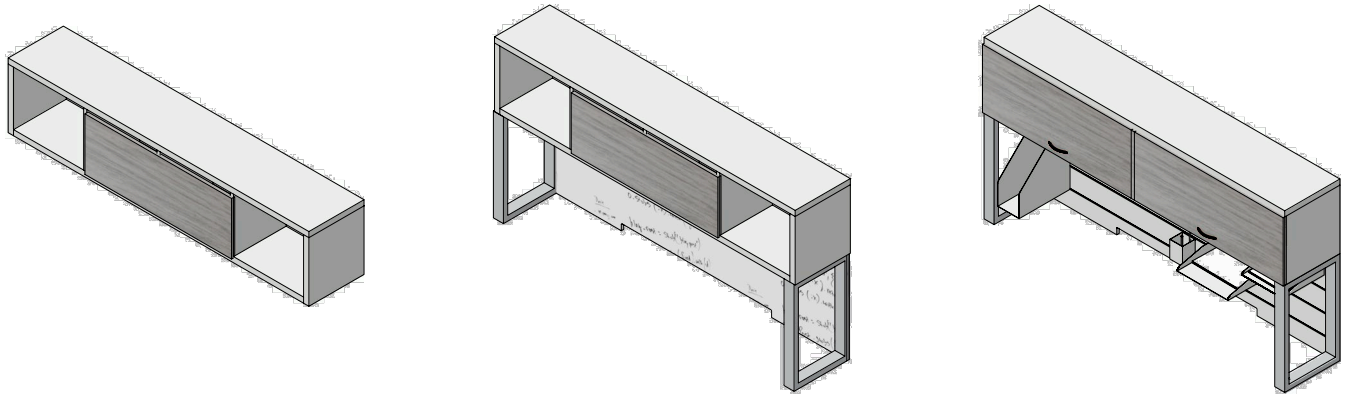

# DESK TOP POWER-BAR

The Power Bar is an above surface assembly designed to carry power and data for above surface applications. It comes with an optional screen and can be daisy chained together for a seamless look. Using the same power components as our panels the open office is no longer limited by its ability to carry power & data. The appropriate box legs should be specified with the Power Bar assembly.

SKU	Nominal Size	State of GA Net Price D & I	
	Length		Description
PB90	36	219.04	POWER BAR - STRUCTURE
PB120	48	249.57	POWER BAR - STRUCTURE
PB150	60	279.73	POWER BAR - STRUCTURE
PBP90	36	75.02	POWER BAR - LAMINATE SCREEN
PBP120	48	99.91	POWER BAR - LAMINATE SCREEN
PBP150	60	125.16	POWER BAR - LAMINATE SCREEN

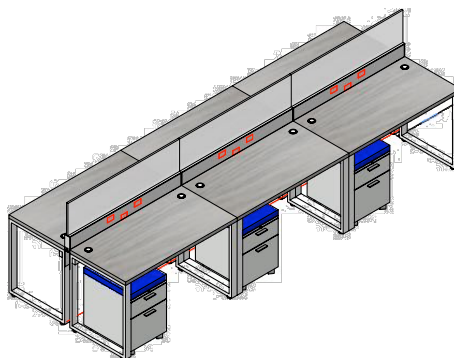

# POWER

Hyer uses Byrne Power Solutions' 8-Trac power system in the raceway of our panels and Power Bar assemblies. 8-Trac is an 8 wire, 4 circuit systems with an isolated ground on circuit 4. Power is specified as part of the design process. Duplexes are circuit specific.

SKU	Nominal Size		State of GA Net Price D & I
	Length		Description
PDH24	24	128.56	Power Distribution Harness
PDH28	28	164.75	Power Distribution Harness
PDH36	36	172.67	Power Distribution Harness
PDH40	40	181.34	Power Distribution Harness
PDH48	48	187.37	Power Distribution Harness
PPH20	20	77.66	Power Pass-thru Harness
PPH24	24	81.43	Power Pass-thru Harness
PPH28	28	85.58	Power Pass-thru Harness
PPH36	36	91.99	Power Pass-thru Harness
PPH40	40	98.02	Power Pass-thru Harness
PPH48	48	107.82	Power Pass-thru Harness
DUP20A	2	19.23	DUPLEX RECEPTACLE
SIF-72	72	168.52	SIDE IN-FEED
PIF-72	72	151.93	END IN-FEED
PIF-END PLUG	48	67.48	END IN-FEED W/20A PLUG
CIF-144	144	136.85	CEILING IN-FEED 12'
CIF-204	204	271.06	CEILING IN-FEED 17'
SBP55PP	120	315.93	POWER OR DATA POLE 10'
AXIL X	72	308.76	DESK TOP POWER MODULE
AXIL Z	72	336.66	IN TOP POWER MODULE
PERNO	24	206.22	LED TASK LIGHT W/OCC SENSOR



# SEATING

SEATING IS NOT AVAILABLE ON STATE OF GA CONTRACT



State of GA Net Price D & I			
SKU	CAPACITY		Description
TANGO	325	546.65	ERGONOMIC CHAIR SPLIT BACK
AVALON	325	778.13	UNIQUE BACK ADJUSTMENT
ATLAS	325	402.64	
SIERRA	300	274.83	TASK CHAIR
SERENO	300	255.23	TASK CHAIR
MARQUEZ	300	162.11	TASK CHAIR FLIP UP ARMS
VELORA 2	275	144.01	TASK CHAIR MOULDED FAOM
ATHENA CHAIR	300	214.14	MOULDED FOAM SEAT
ATHENA STOOL	300	215.27	MOULDED FOAM SEAT
SORRA GUEST	250	151.55	GUEST CHAIR
ISO CHAIR	250	78.79	STACKING CHAIR

## LISBON MODULAR SOFA

Modern, slim lines and elegance describe the Lisbon Sofa. This modular design adapts to any space, offering flexibility, style, and lasting comfort.



# PARTS

Parts are typically included with the cost of the main component. Sometimes in reconfigurations additional parts may be required to fit the new design. In this case parts would need individual pricing.

## CANTILEVERS

State of GA Net Price D & I			
SKU	Length		Description
Cant-L-1	22.5	33	Left hand cantilever for 28" Surfaces
Cant-T-1	22.5	41	shared cantilever 28" Surfaces
Cant-R-1	22.5	33	right hand cantilever 28" Surfaces
Cant-L-2	16.3	21	Left hand cantilever 24" Surfaces
Cant-T-2	16.3	28	shared cantilever 24" Surfaces
Cant-R-2	16.3	21	right hand cantilever 24" Surfaces
Cant-L-3	10.3	20	Left hand cantilever for Shelf
Cant-T-3	10.3	22	shared cantilever for Shelf
Cant-R-3	10.3	20	right hand cantilever for Shelf
3.3 Cant L	3.3	5	Corner/Panel clips
3.3 Cant R	3.3	5	Corner/Panel clips
TCant-L	6.5	8	Left hand cantilever for transaction tops
TCant-T	6.5	10	Shared cantilever for transaction tops
TCant-R	6.5	8	Right hand cantilever for transaction tops

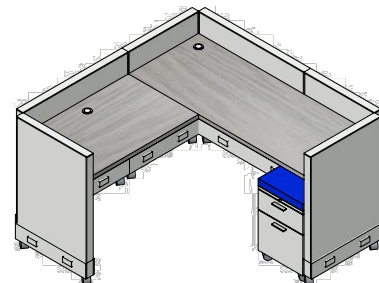
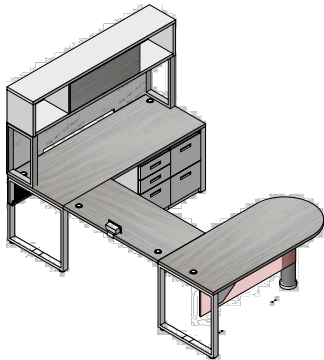

# SCREWS

State of GA Net Price D & I			
SKU	Length	List	Description
Wood Screw	1	0.15	Phillips Head Wood Screw
Machine Screws	1.75	0.25	#8 Machine screw
Self Tapping Machine Screw	1.75	0.25	#8 Self Tapping Machine screw

# CONNECTING KITS

State of GA Net Price D & I						
Height	180°	L	T	X	Y	EOR
45cm - 18"	6	22	24	15	15	20
90cm - 36"	6	24	26	15	15	22
105cm - 42"	6	30	32	15	15	24
135cm - 54"	6	34	36	15	15	26
150cm - 60"	7	36	38	15	15	28
165cm - 65"	7	38	40	15	15	30
180cm - 71"	9	40	45	15	15	32
195cm - 77"	9	45	50	15	15	34
210cm - 83"	10	50	55	15	15	36

# SPECIFICATION RULES/ GUIDELINES

All box legs must be accompanied by either a metal modesty panel (MP-120, MP-150, or MP-180) or a box leg bracket (BLB-L or BLB-R) for stability.

Unsupported top span should be limited to 48" to prevent bowing under a possible heavy load. Work Surface Stretcher Bar (WSS) can be added to reinforce spans greater than 48".

Unsupported or straight 180° wall runs should be limited to 9'.

Always adhere to Federal, State & Local Life Safety and ADA applicable codes.

HYER IS NOT RESPONSIBLE FOR THE IMPROPER DESIGN AND/OR SPECIFICATION AND/OR INSTALLATION PROVIDED BY THE DEALER OR A THIRD PARTY. WE STRONGLY SUGGEST YOU HAVE HYER SPECIFY YOUR PROJECT PRIOR TO ORDER AND USE AN EXPERIENCED CERTIFIED INSTALLER.

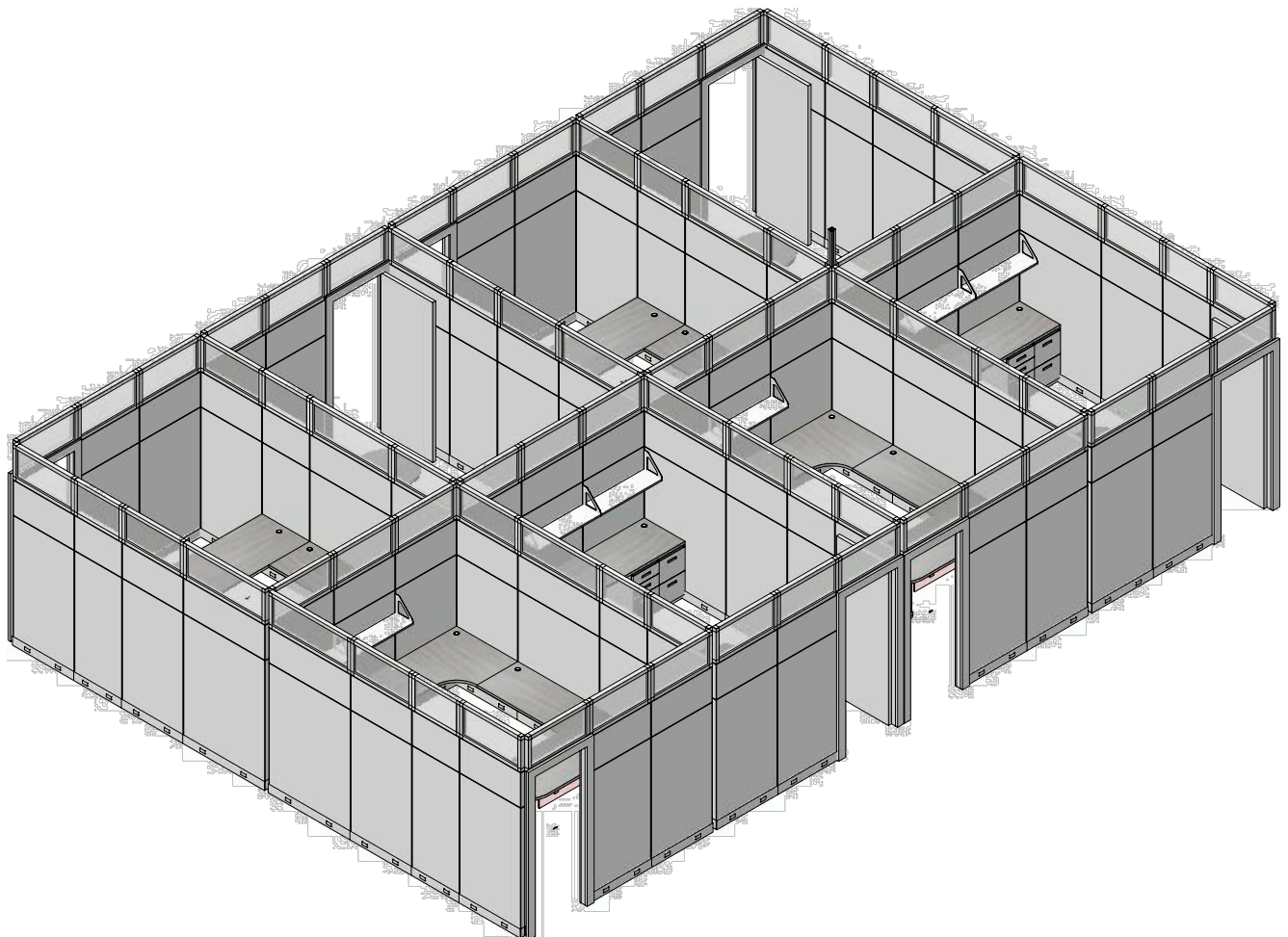



Hyer Office Furniture, Inc.

4103 Tench Road, Suite 400

Suwanee, GA 30024

USA

[www.HyerUSA.com](http://www.HyerUSA.com)

678-990-6844